

Third Floor Plan
Ceiling Height = 12'-2"

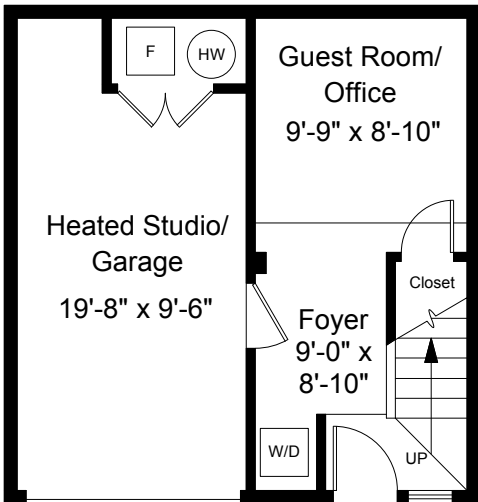

First Floor Plan
Ceiling Height = 7'-1"

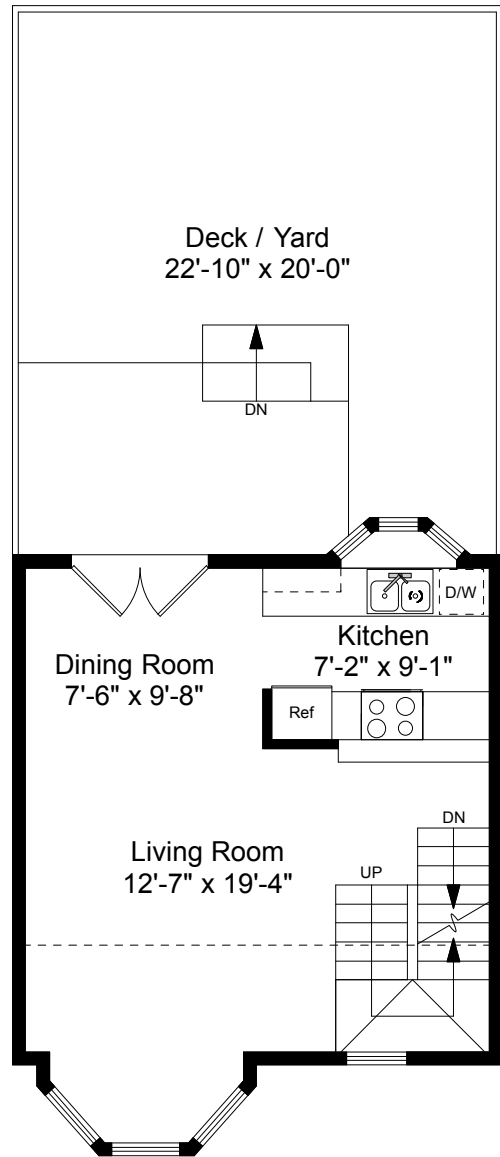

Second Floor Plan
Ceiling Height = 7'-4"

47 Cogswell Avenue, Unit 26
Cambridge, MA 02140



Scale 1/8" = 1'-0"

1

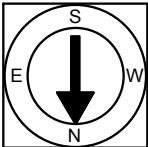

Completed: November 2018

Note: Dimensions are not guaranteed and are provided for informational purposes only. Individual room dimensions are not used to calculate overall square footage.

NATIONAL
— FLOOR PLANS —
& PHOTOGRAPHY
(800) 328-0217